

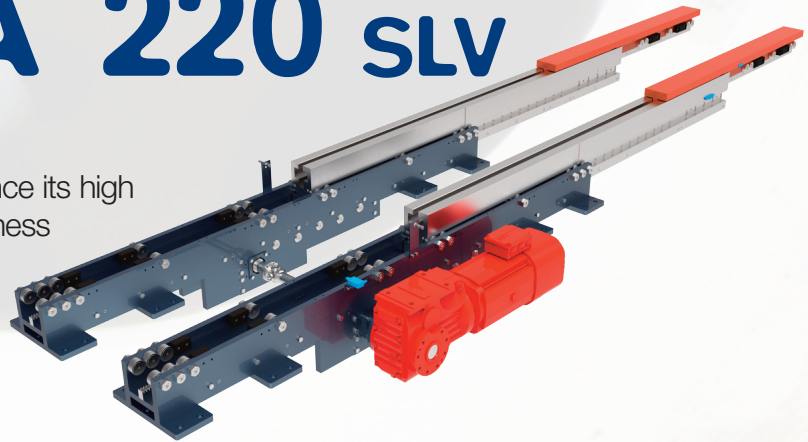

ATHENA 220 SLV

It's a peculiar type of telescopic fork, since its high moment of inertia totally lies in its thickness rather than in its width. It's specifically designed to fit into particularly narrow openings, although it can handle notably heavy loads.



This equipment is made of special materials and innovative solutions have been employed for its develop. It's mainly used in the paper industry to handle big paper coils.

| PRODUCT CODE | Q LOAD (KG) | L FIXED BODY LENGTH (MM) | LS UPPER SLIDE LENGTH (MM) | S1 STROKE (MM) | MAX BENDING UNDER LOAD (MM) |
|--------------|-------------|--------------------------|----------------------------|----------------|-----------------------------|
| AT220-130 | 4000 | 1300 | 1300 | 1400 | 6 |
| AT220-150 | | 1500 | 1500 | 1600 | 9 |
| AT220-170 | | 1700 | 1700 | 1800 | 11 |
| AT220-200 | | 2000 | 2000 | 2100 | 17 |
| AT220-250 | | 2500 | 2500 | 2600 | 30 |
| AT220-290 | 2000 | 2900 | 2900 | 3000 | 25 |

Notably low bending and long life cycle are its strong points. This equipment is the ultimate solution for purposes other forks are not fit for, and it offers remarkable performances as for speed and acceleration. It's only available with the pinions and racks system.

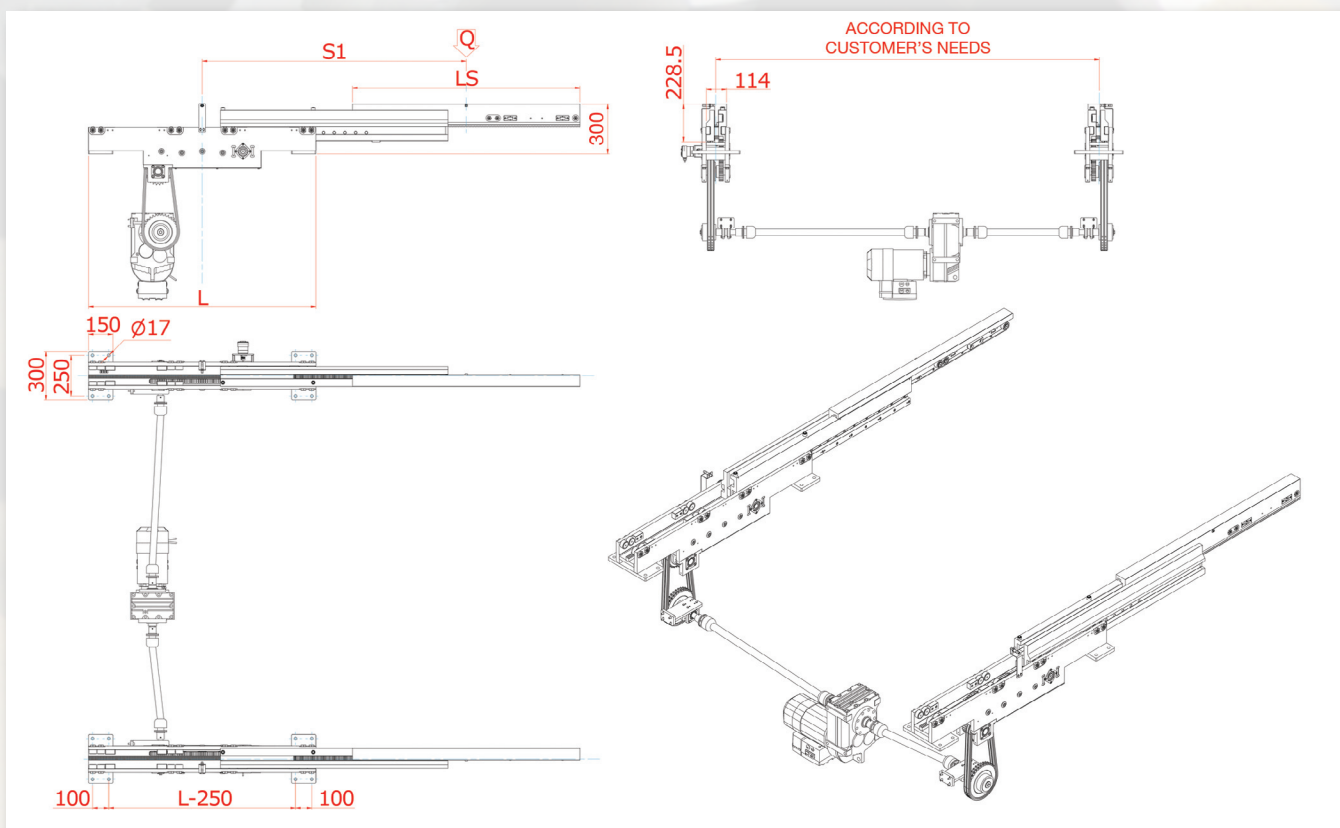

SINGLE DEPTH

DOUBLE DEPTH

TRIPLE DEPTH

COMBINED PRODUCTS

SPECIAL PRODUCTS